



TANK SPECIFICATIONS

CO2 HEAT PUMP HOT WATER SYSTEM WITH
315L DUPLEX STAINLESS STEEL TANK



RECLAIM
ENERGY

TECHNICAL SPECIFICATIONS

SYSTEM CODES:	REHP-CO2-315DX-V2 REHP-KY-CO2-315DX
TANK ID:	RE-DXO-315
TANK CAPACITY:	315L
TANK SIZE:	600mm x 1985mm
WORKING PRESSURE:	700kPa
CONNECTIONS:	BSP RC ¾"

NET WEIGHT:	65kg
MAXIMUM WATER TEMP:	90°C
DIAMETER INNER TANK:	470mm
DIAMETER OUTER TANK:	600mm
TANK OUTER CASING:	Duplex Stainless Steel
TANK INNER:	2205 Duplex Stainless Steel
FOAM INSULATION:	65mm Polyurethane

PROUDLY DESIGNED BY AUSTRALIA'S RENEWABLE ENERGY LEADERS,
THE RECLAIM ENERGY CO2 HEAT PUMP REFLECTS OVER 20 YEARS
OF INNOVATION, SUPERIOR QUALITY AND TRUSTED RELIABILITY.

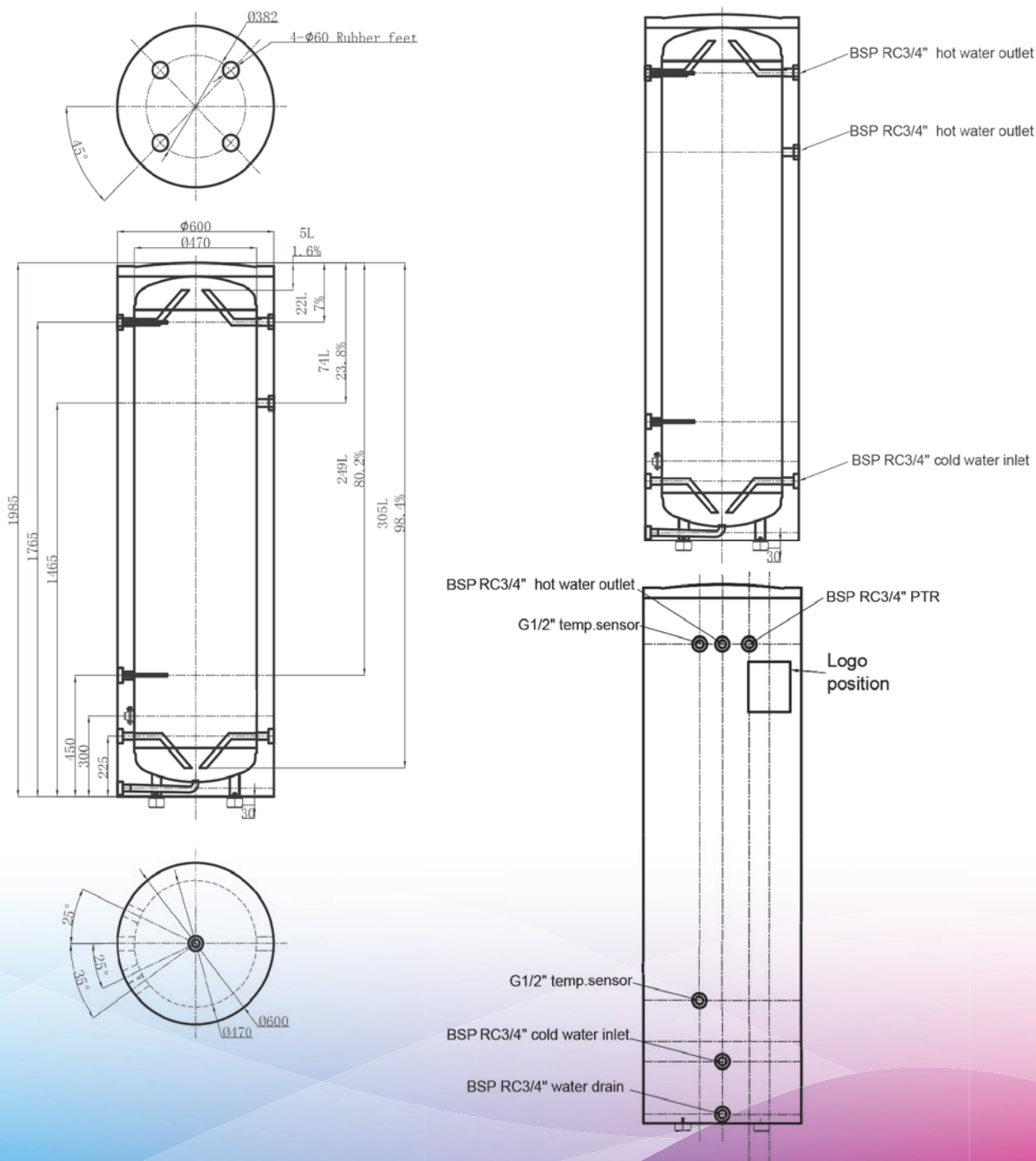

CONTACT US &
FIND OUT MORE
HERE



1300 383 815

HELLO@RECLAIMENERGY.COM.AU

RECLAIMENERGY.COM.AU

facebook.com/CO2HeatPump



instagram.com/reclaimenergy



linkedin.com/company/reclaim-energy



RECLAIM
ENERGY